

Soils Map

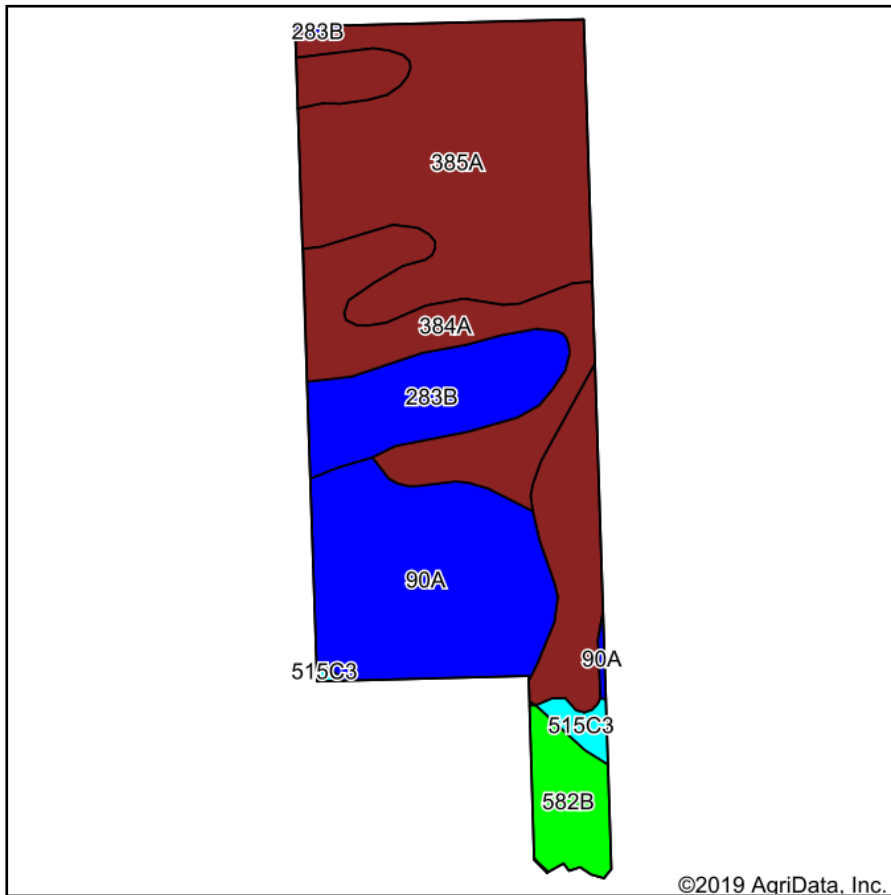

Soils data provided by USDA and NRCS.

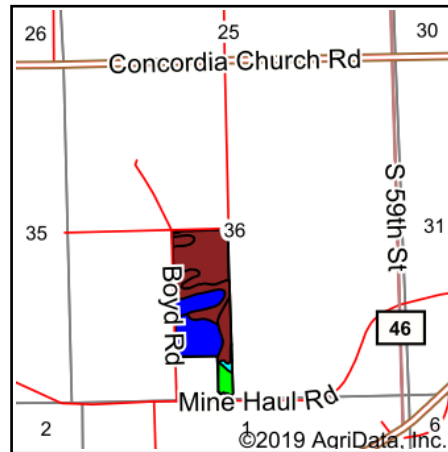

State: **Illinois**
 County: **St Clair**
 Location: **36-1N-9W**
 Township: **Stokey**
 Acres: **43.08**
 Date: **2/6/2020**

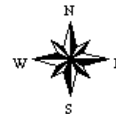

Area Symbol: IL163. Soil Area Version: 11									
Code	Soil Description	Acres	Percent of field	Il. State Productivity Index Legend	Corn Bu/A	Soybeans Bu/A	Wheat Bu/A	Alfalfa d hay, T/A	Crop productivity index for optimum management
385A	Mascoutah silty clay loam, 0 to 2 percent slopes	18.23	42.3%		194	61	71	0.00	141
90A	Bethalto silt loam, 0 to 2 percent slopes	9.62	22.3%		183	57	71	0.00	134
384A	Edwardsville silt loam, 0 to 2 percent slopes	7.80	18.1%		194	59	75	0.00	141
**283B	Downsouth silt loam, 2 to 5 percent slopes	4.67	10.8%		**182	**56	**69	**6.34	**135
**582B	Homen silt loam, 2 to 5 percent slopes	2.19	5.1%		**149	**47	**55	**3.72	**108
**515C3	Bunkum silty clay loam, 5 to 10 percent slopes, severely eroded	0.57	1.3%		**126	**43	**48	**3.35	**95
Weighted Average					187.1	58.3	70.4	0.92	136.5

Table: Optimum Crop Productivity Ratings for Illinois Soil by K.R. Olson and J.M. Lang, Office of Research, ACES, University of Illinois at Champaign-Urbana. Version: 1/2/2012 Amended Table S2 B811
 Crop yields and productivity indices for optimum management (B811) are maintained at the following NRES web site: <http://soilproductivity.nres.illinois.edu/>
 ** Indexes adjusted for slope and erosion according to Bulletin 811 Table S3
 d Soils in the poorly drained group were not rated for alfalfa and are shown with a zero "0".
 *c: Using Capabilities Class Dominant Condition Aggregation Method
 Soils data provided by USDA and NRCS. Soils data provided by University of Illinois at Champaign-Urbana.