

# Soils Map

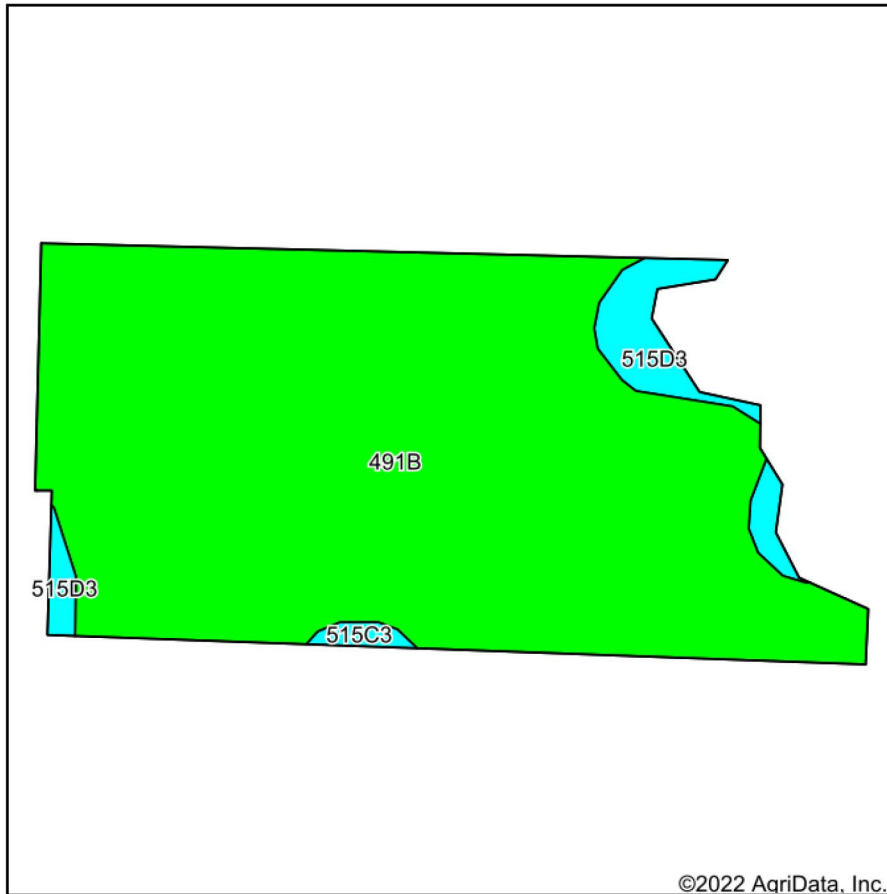

Soils data provided by USDA and NRCS.

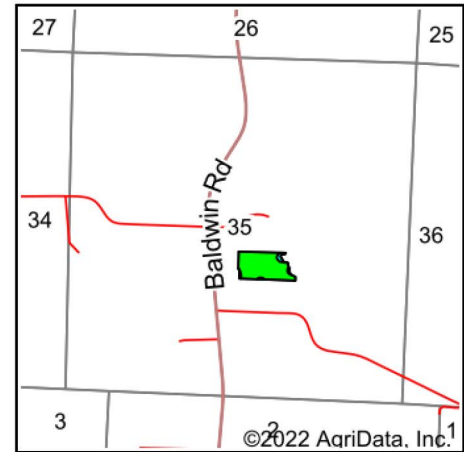

State: **Illinois**  
 County: **Randolph**  
 Location: **35-4S-7W**  
 Township: **Baldwin**  
 Acres: **7.69**  
 Date: **6/6/2022**

Maps Provided By:



Area Symbol: IL157, Soil Area Version: 15

Code	Soil Description	Acres	Percent of field	Il. State Productivity Index Legend	Corn Bu/A	Soybeans Bu/A	Wheat Bu/A	Alfalfa <i>d</i> hay, T/A	Crop productivity index for optimum management
**491B	Ruma silt loam, 2 to 5 percent slopes	7.27	94.5%		**160	**48	**59	**4.84	**115
**515D3	Bunkum silty clay loam, 10 to 18 percent slopes, severely eroded	0.42	5.5%		**118	**41	**45	**3.15	**89
Weighted Average					157.7	47.6	58.2	4.75	113.6

**Table: Optimum Crop Productivity Ratings for Illinois Soil by K.R. Olson and J.M. Lang, Office of Research, ACES, University of Illinois at Champaign-Urbana.** Version: 1/2/2012 Amended Table S2 B811

Crop yields and productivity indices for optimum management (B811) are maintained at the following NRES web site: <http://soilproductivity.nres.illinois.edu/>

\*\* Indexes adjusted for slope and erosion according to Bulletin 811 Table S3

*d* Soils in the poorly drained group were not rated for alfalfa and are shown with a zero "0".

Soils data provided by USDA and NRCS. Soils data provided by University of Illinois at Champaign-Urbana.