



Description – Jeffrey & Marcia Watters and Claud & Ann Watters
1.3 Acre Tract #1

2023-007897
February 24, 2023

A tract of land lying in Lot 1 of Block 4 of Kaskaskia Hills “Lake Mildred” Subdivision in the Southwest Quarter of Section 5, and the Southeast Quarter of Section 6, and in Survey #743, Claim #93, Township 5 South, Range 9 West of the 3rd Principal Meridian and being more fully described as follows to-wit:

Beginning at a found Stone marking the Quarter Corner common to said Sections 5 & 6; thence South 89 degrees, 36 minutes and 39 seconds East along the East-West centerline of said Section 5 a distance of 60.00 feet to the Northeast Corner of Lot 1 of Block 4 of Kaskaskia Hills “Lake Mildred” Subdivision, from which a found iron bar bears North 53 degrees, 28 minutes and 33 seconds West 2.03 feet; thence South 00 degrees, 12 minutes and 30 seconds West leaving said East-West centerline and along the East line of said Lot 1 a distance of 91.67 feet to the Southeast Corner of said Lot 1, from which a found iron bar bears North 75 degrees, 47 minutes and 16 seconds East 4.18 feet; thence Westerly leaving said East line and along the North line of Pin Oak Drive and along a 49 degree, 49 minute and 21 second curve to the left having a central angle of 61 degrees, 27 minutes and 30 seconds, an arc length of 123.35 feet and chord of South 30 degrees, 58 minutes and 15 seconds West 117.53 feet to a 5/8” iron pin marking the Southwest Corner of said Lot 1; thence South 00 degree, 14 minutes and 30 seconds West along the West line of said Pin Oak Drive 223.00 feet to a 5/8” iron pin; thence South 88 degrees, 05 minutes and 28 seconds West leaving said West line 157.95 feet to the centerline of “G” Road, from which a 5/8” iron pin bears North 88 degrees, 05 minutes and 28 seconds East 30.00 feet; thence North 03 degrees, 05 minutes and 23 seconds East along said centerline 422.65 feet to the East-West centerline of said Section 6, from which a 5/8” iron pin bears South 89 degrees, 31 minutes and 54 seconds East 30.00 feet; thence South 89 degrees, 31 minutes and 54 seconds East leaving said “G” Road centerline and along the East-West centerline of said Section 6 a distance of 136.84 feet to the Point of Beginning, containing 1.3 Acres, more or less, with the above described being subject to easements and rights-of-way of record or not of record, if any. As per survey #2023-007897 of John D. Janes, Illinois Professional Land Surveyor #035-04044 during February of 2023.

Prepared by
JANES SURVEYING, Inc.
222 South Main
Palmyra, Missouri 63461

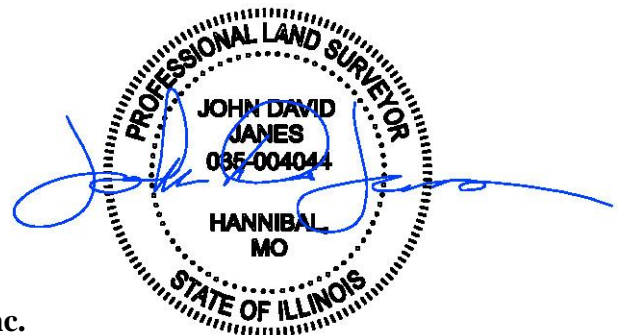

February 24, 2023

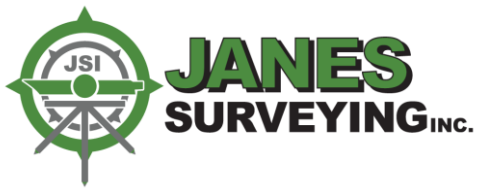

Description – Jeffrey & Marcia Watters and Claud & Ann Watters
1.3 Acre Tract #2

2023-007897
February 24, 2023

Suggested legal description:

All of Lots 2, 3, 4, 5, 6 & 7 of Block 4 of Kaskaskia Hills “Lake Mildred” Subdivision, a subdivision lying in the Southwest Quarter of Section 5 and in Survey #743, Claim #93, Township 5 South, Range 9 West of the 3rd Principal Meridian, Monroe County, Illinois. As per survey #2023-007897 of John D. Janes, Illinois Professional Land Surveyor #035-04044 during February of 2023.

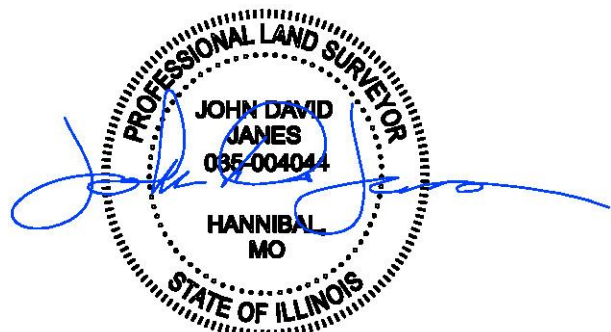

February 24, 2023

Prepared by
JANES SURVEYING, Inc.
222 South Main
Palmyra, Missouri 63461



Description – Jeffrey & Marcia Watters and Claud & Ann Watters
1.7 Acre Tract #2A

2023-007897
February 24, 2023

Suggested legal description:

All of Lots 1, 2, 4, 5, 6, 8, 11, 12 & 15 of Block 3 of Kaskaskia Hills “Lake Mildred” Subdivision, a subdivision lying in the Southwest Quarter of Section 5 and in Survey #743, Claim #93, Township 5 South, Range 9 West of the 3rd Principal Meridian, Monroe County, Illinois. As per survey #2023-007897 of John D. Janes, Illinois Professional Land Surveyor #035-04044 during February of 2023.

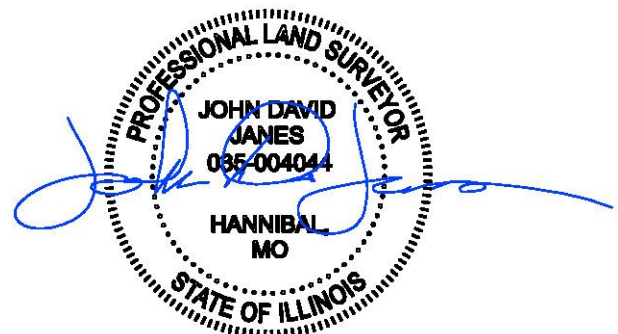

February 24, 2023

Prepared by
JANES SURVEYING, Inc.
222 South Main
Palmyra, Missouri 63461

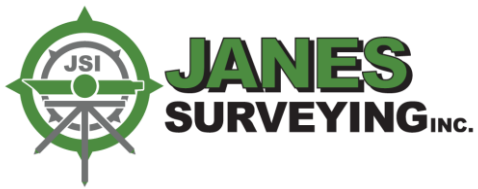

Description – Jeffrey & Marcia Watters and Claud & Ann Watters
0.8 Acre Tract #2B

2023-007897
February 24, 2023

Suggested legal description:

All of Lots 9, 10, 13 & 14 of Block 3 of Kaskaskia Hills “Lake Mildred” Subdivision, a subdivision lying in the Southwest Quarter of Section 5 and in Survey #743, Claim #93, Township 5 South, Range 9 West of the 3rd Principal Meridian, Monroe County, Illinois. As per survey #2023-007897 of John D. Janes, Illinois Professional Land Surveyor #035-04044 during February of 2023.

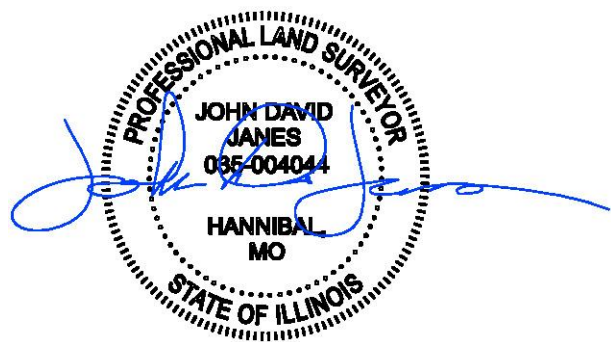

February 24, 2023

Prepared by
JANES SURVEYING, Inc.
222 South Main
Palmyra, Missouri 63461



Description – Jeffrey & Marcia Watters and Claud & Ann Watters
1.7 Acre Tract #3

2023-007897
February 24, 2023

Suggested legal description:

All of Lots 13, 14, 15, 16, 17, 18, 19, 20, 21 & 22 of Block 5 of Kaskaskia Hills “Lake Mildred” Subdivision, a subdivision lying in the Southwest Quarter of Section 5 and in Survey #743, Claim #93, Township 5 South, Range 9 West of the 3rd Principal Meridian, Monroe County, Illinois. As per survey #2023-007897 of John D. Janes, Illinois Professional Land Surveyor #035-04044 during February of 2023.

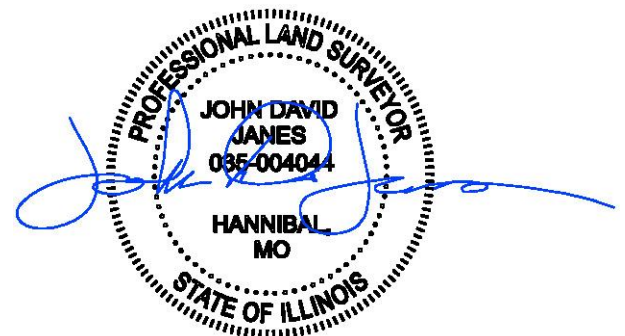

February 24, 2023

Prepared by
JANES SURVEYING, Inc.
222 South Main
Palmyra, Missouri 63461



Description – Jeffrey & Marcia Watters and Claud & Ann Watters
12.4 Acre Tract #4 – Page 1 of 2

2023-007897
February 24, 2023

A tract of land lying in the Southwest Quarter of Section 5, Township 5 South, Range 9 West of the 3rd Principal Meridian and being more fully described as follows to-wit:

Beginning at a 5/8" iron pin marking the Northernmost Corner of Lot 14 of Block 8 of Kaskaskia Hills "Lake Mildred" Subdivision Plat 2, a subdivision lying in the Southwest Quarter of Section 5 and in Survey #743, Claim #93; thence South 07 degrees, 00 minutes and 38 seconds West along the West line of said Lot 14 a distance of 170.00 feet to a 5/8" iron pin marking the Northwest Corner of Lot 12 of said Block 8; thence South 82 degrees, 59 minutes and 17 seconds East leaving said West line and along the North line of Lots 12 & 13 of said Block 8 a distance of 119.93 feet to a 5/8" iron pin marking the Northeast Corner of said Lot 13; thence South 07 degrees, 05 minutes and 38 seconds West leaving said North line and along the West line of Shady Lane 100.00 feet to a 5/8" iron pin; thence Southerly along said West line and along a 286 degree, 03 minute and 45 second curve to the right having a central angle of 89 degrees, 54 minutes and 59 seconds, an arc length of 31.43 feet and a chord of South 52 degrees, 03 minutes and 08 seconds West 28.30 feet to a 5/8" iron pin on the North line of Hickory Hill Drive; thence North 82 degrees, 59 minutes and 22 seconds West leaving said West line and along the North line of said Hickory Hill Drive 55.54 feet to a 5/8" iron pin; thence North 71 degrees, 44 minutes and 22 seconds West along said North line 570.04 feet to a 5/8" iron pin; thence Westerly along said North line and along a 286 degree, 28 minute and 44 second curve to the right having a central angle of 89 degrees, 59 minutes and 58 seconds, an arc length 31.42 feet and chord of North 26 degrees, 44 minutes and 21 seconds West 28.28 feet to a 5/8" iron pin on the West line of Lot 1 of said Block 8; thence North 18 degrees, 15 minutes and 38 seconds East leaving said North line and along said West line 120.05 feet to a 5/8" iron pin marking the Northwest Corner of said Lot 1; thence North 71 degrees, 44 minutes and 22 seconds West leaving said West line and parallel with the North line of said Hickory Hill Drive 50.00 feet to a 5/8" iron pin marking the Northeast Corner of Lot 1 of Block 6 of said Kaskaskia Hills "Lake Mildred" Subdivision Plat 2; thence South 18 degrees, 15 minutes and 38 seconds West along the East line of said Lot 1 a distance of 120.00 feet; thence Southerly along said East line and along a 286 degree, 28 minute and 44 second curve to the right having a central angle of 90 degrees, 00 minute and 00 seconds, an arc length of 31.42 feet and a chord of South 63 degrees, 15 minutes and 38 seconds West 28.28 feet to a 5/8" iron pin on the North line of said Hickory Hill Drive; thence North 71 degrees, 44 minutes and 22 seconds West leaving said East line and along said North line 217.19 feet to a 5/8" iron pin; thence South 46 degrees, 38 minutes and 08 seconds West along said North line 13.41 feet to a 5/8" iron pin marking the Southwest Corner of Lot 6 of said Block 6;

thence North 25 degrees, 29 minutes and 40 seconds West leaving said North line and along the West line of said Lot 6 a distance of 188.70 feet to a 5/8” iron pin marking the Northwest Corner of said Lot 6; thence South 66 degrees, 24 minutes and 46 seconds West leaving said West line and along the Northwesterly line of Lot 7 of said Block 6 a distance of 90.12 feet to a 5/8” iron pin; thence South 11 degrees, 32 minutes and 22 seconds West leaving said Northwesterly line and along the West line of Lots 7 & 8 of said Block 6 a distance of 212.56 feet to the Southwest Corner of Lot 8 of said Block 6, from which a 5/8” iron pin bears North 11 degrees, 32 minutes and 22 seconds East 45.00 feet; thence South 32 degrees, 35 minutes and 10 seconds East leaving said West line and along the West line of said Block 6 a distance of 218.32 feet; thence South 20 degrees, 28 minutes and 30 seconds East along said West line 147.55 feet to the Southwest Corner of Lot 15 of said Block 6; thence North 82 degrees, 36 minutes and 24 seconds West leaving said West line 324.33 feet to the East Line of Lot 21 of Block 5 of Kaskaskia Hills “Lake Mildred” Subdivision; thence North 34 degrees, 26 minutes and 01 second West along the East line of said Block 5 a distance of 146.59 feet; thence North 11 degrees, 46 minutes and 06 seconds West along said East line 143.82 feet to the Southeast Corner of Lot 27 of said Block 5; thence North 20 degrees, 57 minutes and 30 seconds East along said East line 106.42 feet to a 5/8” iron pin marking the Northeast Corner of Lot 28 of said Block 5; thence North 15 degrees, 49 minutes and 30 seconds East leaving said East line 150.00 feet to a 5/8” iron pin; thence North 64 degrees, 10 minutes and 30 seconds West 130.00 feet to a 5/8” iron pin on the East line of Oak Tree Lane; thence North 15 degrees, 49 minutes and 30 seconds East along said East line 65.67 feet to a 5/8” iron pin; thence South 89 degrees, 47 minutes and 30 seconds East leaving said West line 1326.31 feet to a 5/8” iron pin; thence South 00 degrees, 12 minutes and 30 seconds West 238.43 feet to the Point of Beginning, containing 12.4 Acres, more or less, with the above described being subject to easements and rights-of-way of record or not of record, if any. As per survey #2023-007897 of John D. Janes, Illinois Professional Land Surveyor #035-04044 during February of 2023.

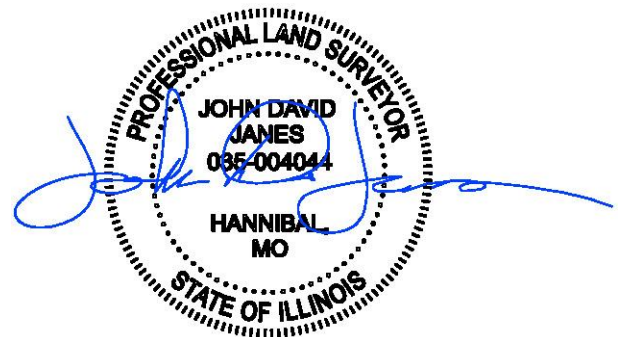



Description – Jeffrey & Marcia Watters and Claud & Ann Watters
1.9 Acre Tract #5

2023-007897
February 24, 2023

Suggested legal description:

All of Lots 3, 4, 5, 6, 7, 8, 9, 11, 12, 13 & 14 of Block 7 of Kaskaskia Hills “Lake Mildred” Subdivision Plat 2, a subdivision lying in the Southwest Quarter of Section 5 and in Survey #743, Claim #93, Township 5 South, Range 9 West of the 3rd Principal Meridian, Monroe County, Illinois. As per survey #2023-007897 of John D. Janes, Illinois Professional Land Surveyor #035-04044 during February of 2023.

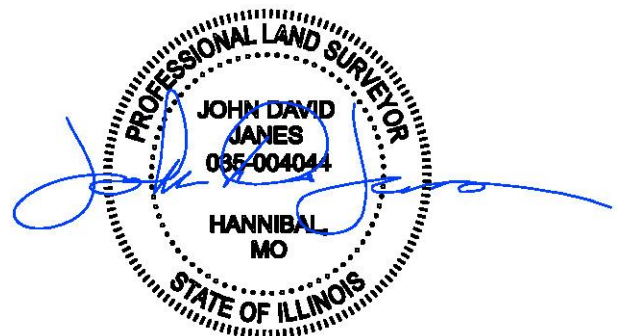

February 24, 2023

Prepared by
JANES SURVEYING, Inc.
222 South Main
Palmyra, Missouri 63461



Description – Jeffrey & Marcia Watters and Claud & Ann Watters
5.1 Acre Tract #6

2023-007897
February 24, 2023

A tract of land lying in the Southwest Quarter of Section 5, Township 5 South, Range 9 West of the 3rd Principal Meridian and being more fully described as follows to-wit:

Beginning at a 5/8" iron pin marking the Northwest Corner of Lot 15 of Block 8 of Kaskaskia Hills "Lake Mildred" Subdivision Plat 2, a subdivision lying in the Southwest Quarter of Section 5 and in Survey #743, Claim #93; thence North 00 degrees, 12 minutes and 30 seconds East 238.43 feet to a 5/8" iron pin; thence South 89 degrees, 47 minutes and 30 seconds East 827.75 feet to a 5/8" iron pin marking the Northeast Corner of Kaskaskia Hills "Lake Mildred" Subdivision Plat 2; thence South 00 degrees, 06 minutes and 25 seconds East 87.90 feet to a 5/8" iron pin on the North line of Shady Lane; thence South 59 degrees, 10 minutes and 38 seconds West along said North line 290.38 feet to a 5/8" iron pin; thence South 52 degrees, 10 minutes and 20 seconds West along said North line 268.70 feet to a 5/8" iron pin; thence North 82 degrees, 59 minutes and 22 seconds West along said North line 169.69 feet to a 5/8" iron pin marking the Southwest Corner of Lot 17 of Block 8 of said Kaskaskia Hills "Lake Mildred" Subdivision Plat 2; thence North 07 degrees, 00 minutes and 38 seconds East leaving said North line and along the West line of said Lot 17 a distance of 120.00 feet to a 5/8" iron pin marking the Northwest Corner of said Lot 17; thence North 85 degrees, 59 minutes and 22 seconds West leaving said West line and along the North line of Lots 15 & 16 of said Block 8 a distance of 215.00 feet to the Point of Beginning, containing 5.1 Acres, more or less, with the above described being subject to easements and rights-of-way of record or not of record, if any. As per survey #2023-007897 of John D. Janes, Illinois Professional Land Surveyor #035-04044 during February of 2023.

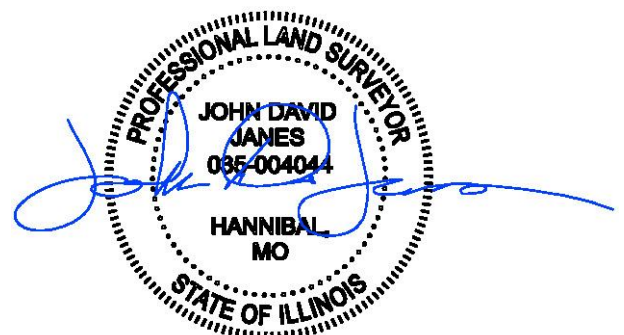

February 24, 2023

Prepared by
JANES SURVEYING, Inc.
222 South Main
Palmyra, Missouri 63461



Description – Jeffrey & Marcia Watters and Claud & Ann Watters
1.3 Acre Tract #6A

2023-007897
February 24, 2023

Suggested legal description:

The area platted as “Sink Area” in Block 11 of Kaskaskia Hills “Lake Mildred” Subdivision Plat 2, a subdivision lying in the Southwest Quarter of Section 5 and in Survey #743, Claim #93, Township 5 South, Range 9 West of the 3rd Principal Meridian, Monroe County, Illinois. As per survey #2023-007897 of John D. Janes, Illinois Professional Land Surveyor #035-04044 during February of 2023.

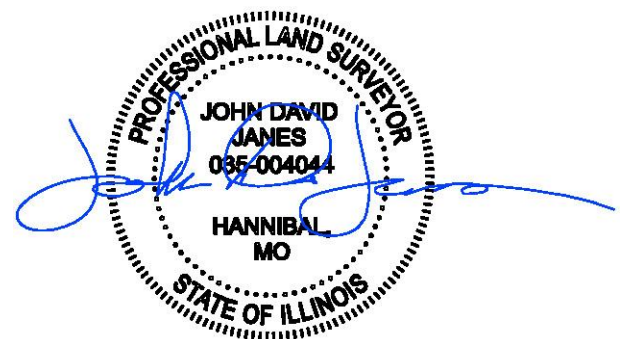

February 24, 2023

Prepared by
JANES SURVEYING, Inc.
222 South Main
Palmyra, Missouri 63461



Description – Jeffrey & Marcia Watters and Claud & Ann Watters
1.3 Acre Tract #6B

2023-007897
February 24, 2023

Suggested legal description:

All of Lots 1, 2, 3, 4, 5, and the area platted as Park “A”, all in Block 9 of Kaskaskia Hills “Lake Mildred” Subdivision Plat 2, a subdivision lying in the Southwest Quarter of Section 5 and in Survey #743, Claim #93, Township 5 South, Range 9 West of the 3rd Principal Meridian, Monroe County, Illinois. As per survey #2023-007897 of John D. Janes, Illinois Professional Land Surveyor #035-04044 during February of 2023.

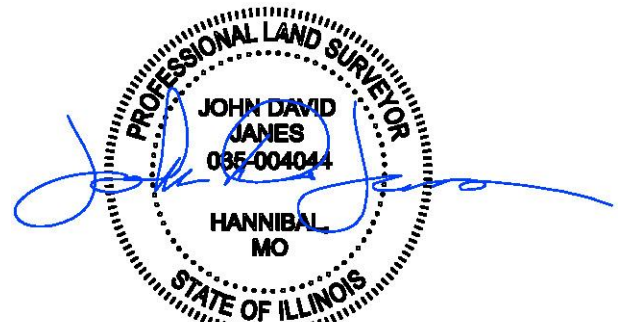

February 24, 2023

Prepared by
JANES SURVEYING, Inc.
222 South Main
Palmyra, Missouri 63461



Description – Jeffrey & Marcia Watters and Claud & Ann Watters
0.5 Acre Tract #6C

2023-007897
February 24, 2023

Suggested legal description:

All of Lots 7, 8 & 9 of Block 9 of Kaskaskia Hills “Lake Mildred” Subdivision Plat 2, a subdivision lying in the Southwest Quarter of Section 5 and in Survey #743, Claim #93, Township 5 South, Range 9 West of the 3rd Principal Meridian, Monroe County, Illinois. As per survey #2023-007897 of John D. Janes, Illinois Professional Land Surveyor #035-04044 during February of 2023.

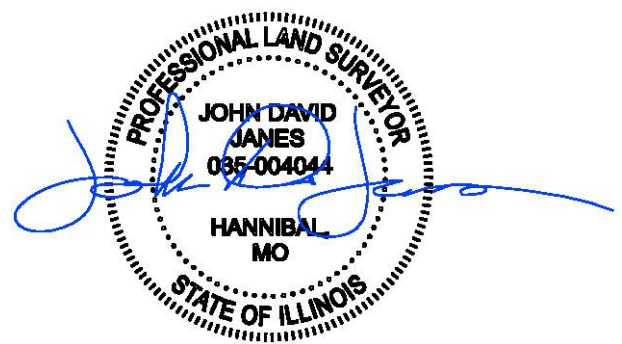

February 24, 2023

Prepared by
JANES SURVEYING, Inc.
222 South Main
Palmyra, Missouri 63461



Description – Jeffrey & Marcia Watters and Claud & Ann Watters
33.8 Acre Tract #7 – Page 1 of 3

2023-007897
Revised – March 9, 2023

A tract of land lying in the Southwest Quarter of Section 5, Township 5 South, Range 9 West of the 3rd Principal Meridian and being more fully described as follows to-wit:

Beginning at a 5/8" iron pin marking the Northeast Corner of Lot 16 of Block 6 of Kaskaskia Hills "Lake Mildred" Subdivision Plat 2, a subdivision lying in the Southwest Quarter of Section 5 and in Survey #743, Claim #93; thence South 14 degrees, 59 minutes and 22 seconds East along the West line of Lake Front Drive 157.94 feet to a 5/8" iron pin marking the Southeast Corner of Lot 18 of said Block 6; thence South 39 degrees, 55 minutes and 07 seconds East along said West line 79.57 feet to a 5/8" iron pin; thence South 64 degrees, 04 minutes and 22 seconds East along said West line 61.81 feet to a 5/8" iron pin; thence Southerly along said West line and along a 286 degree, 28 minute and 44 second curve to the right having a central angle of 105 degrees, 00 minutes and 00 seconds, an arc length of 36.65 feet and a chord of South 11 degrees, 34 minutes and 22 seconds East 31.73 feet to a 5/8" iron pin on the North line of Demint Court; thence South 40 degrees, 55 minutes and 38 seconds West leaving said West line and along said North line 11.28 feet to a 5/8" iron pin; thence Southerly & Easterly along said Demint Court and along a 143 degree, 14 minute and 22 second curve to the left having a central angle of 281 degrees, 07 minutes and 03 seconds, an arc length of 196.26 feet and a chord of South 49 degrees, 50 minutes and 00 seconds East 50.82 feet to a 5/8" iron pin on the South line of said Demint Court; thence North 40 degrees, 55 minutes and 38 seconds East along said South line 228.55 feet to a 5/8" iron pin; thence Easterly along said South line and along a 286 degree, 28 minute and 44 second curve to the right having a central angle of 108 degrees, 10 minutes and 00 seconds, an arc length of 37.76 feet and a chord of South 84 degrees, 59 minutes and 22 seconds East 32.39 feet to a 5/8" iron pin on the South line of Lake View Drive; thence South 30 degrees, 54 minutes and 22 seconds East leaving the South line of Demint Court and along the South line of said Lake View Drive 15.22 feet to a 5/8" iron pin on the West line of Lake Shore Drive; thence South 00 degrees, 35 minutes and 38 seconds West leaving said South line and along said West line 170.08 feet to a 5/8" iron pin; thence South 78 degrees, 44 minutes and 22 seconds East along said West line 190.03 feet to a 5/8" iron pin; thence North 11 degrees, 15 minutes and 38 seconds East leaving said West line 50.00 feet to a 5/8" iron pin on the East line of said Lake Shore Drive; thence North 78 degrees, 44 minutes and 22 seconds West along said East line 148.57 feet to a 5/8" iron pin; thence North 00 degrees, 35 minutes and 38 seconds East along said East line 79.53 feet to a 5/8" iron pin; thence Northeasterly along said East line and along a 286 degree, 28 minute and 44 second curve to the right having a central angle of 121 degrees, 43 minutes and 06 seconds, an arc length of 42.49 feet and a chord of North 61 degrees, 27 minutes and 11 seconds East 34.94 feet to a 5/8" iron pin on the South line of Lake View Drive;

thence South 57 degrees, 41 minutes and 16 seconds East leaving said East line and along said South line 151.54 feet to a 5/8" iron pin; thence South 87 degrees, 41 minutes and 37 seconds East along said South line 369.86 feet to a 5/8" iron pin; thence South 64 degrees, 19 minutes and 22 seconds East along said South line 274.95 feet to a 5/8" iron pin; thence North 79 degrees, 40 minutes and 38 seconds East along said South line 280.10 feet to a 5/8" iron pin marking the Southwest Corner of Lot 5 of Block 12 Kaskaskia Hills "Lake Mildred" Subdivision Plat 2; thence North 01 degree, 39 minutes and 20 seconds West along the East line of Lake View Drive 179.99 feet to a 5/8" iron pin marking the Northwest Corner of Lot 3 in said Block 12; thence North 88 degrees, 20 minutes and 38 seconds East leaving said East line and along the North line of said Lot 3 a distance of 117.80 feet to a 5/8" iron pin marking the Northeast Corner of said Lot 3; thence South 00 degrees, 06 minutes and 25 seconds East leaving said North line and along the East line of Lots 3, 4 & 5 of said Block 12 a distance of 180.06 feet to the Southeast Corner of said Lot 5; thence South 00 degrees, 10 minutes and 02 seconds East leaving said common Lot line and along the North-South centerline of said Section 5 a distance of 328.22 feet to a 5/8" iron pin; thence North 84 degrees, 48 minutes and 06 seconds West leaving said North-South centerline 582.07 feet to a 5/8" iron pin marking the Northeast Corner of Lot 1 of Block 14 of Kaskaskia Hills "Lake Mildred" Subdivision; thence North 79 degrees, 45 minutes and 11 seconds West along the North line of said Lot 1 a distance of 213.38 feet to a 5/8" iron pin marking the Northwest Corner of said Lot 1; thence South 78 degrees, 21 minutes and 19 seconds West leaving said North line 54.40 feet to a 5/8" iron pin marking the Northeast Corner of Lot 1 of Block 15 of Kaskaskia Hills "Lake Mildred" Subdivision; thence South 50 degrees, 56 minutes and 30 seconds West along the North line of said Lot 1 a distance of 255.94 feet to a 5/8" iron pin marking the Northwest Corner of said Lot 1; thence South 61 degrees, 29 minutes and 11 seconds West leaving said North line 642.59 feet to a found iron pipe; thence North 49 degrees, 56 minutes and 19 seconds West 242.00 feet to a 5/8" iron pin; thence South 46 degrees, 30 minutes and 33 seconds West 444.50 feet to a 5/8" iron; thence North 56 degrees, 29 minutes and 27 seconds West 188.05 feet to a found iron pipe; thence South 32 degrees, 26 minutes and 41 seconds West 189.40 feet to a found 5/8" iron pin; thence North 56 degrees, 27 minutes and 12 seconds West 341.04 feet to a 5/8" iron pin; thence North 33 degrees, 39 minutes and 04 seconds East 186.37 feet to a point from which a 5/8" iron pin bears South 33 degrees, 39 minutes and 04 seconds West 25.00 feet and a 5/8" iron pin bears North 56 degrees, 57 minutes and 42 seconds West 30.00 feet; thence North 56 degrees, 57 minutes and 42 seconds West 122.74 feet to a 5/8" iron pin;

thence North 65 degrees, 51 minutes and 43 seconds East 137.18 feet to the East line of Black Oak Drive, from which a 5/8” iron pin bears South 65 degrees, 51 minutes and 43 seconds West 20.00 feet and a 5/8” iron pin bears North 03 degrees, 33 minutes and 35 seconds West 15.00 feet; thence North 03 degrees, 33 minutes and 35 seconds West along said East line 48.65 feet to a 5/8” iron pin; thence South 87 degrees, 36 minutes and 12 Seconds East leaving said East line 69.85 feet to a point from which a 5/8” iron pin bears North 87 degrees, 36 minutes and 12 seconds West 52.00 feet; thence North 28 degrees, 25 minutes and 52 seconds East 91.70 feet to a 5/8” iron pin; thence North 59 degrees, 51 minutes and 04 seconds East along the South line of Lots 3 & 4 of Block 5 of Kaskaskia Hills “Lake Mildred” Subdivision 290.74 feet to the Southwest Corner of Lot 5 of said Block 5; thence North 64 degrees, 16 minutes and 23 seconds East leaving the South line of said Lots 3 & 4 and along the South line of said Lot 5 a distance of 103.75 feet to the Southwest Corner of Lot 6 in said Block 5; thence North 33 degrees, 49 minutes and 23 seconds East leaving the South line of said Lot 5 and along the South line of said Lot 6 a distance of 103.96 feet to the Northeast Corner of Lot 6; thence North 46 degrees, 24 minutes and 48 seconds West leaving the South line of said Lot 6 and along the East line of Lot 7 of said Block 5 a distance of 122.95 feet to a 5/8” iron pin marking the Southeast Corner of Lot 8 of said Block 5; thence North 05 degrees, 38 minutes and 49 seconds East leaving the East line of said Lot 7 and along the East line of said Lot 8 a distance of 96.20 feet to a 5/8” iron pin marking the Northeast Corner of said Lot 8; thence North 44 degrees, 45 minutes and 21 seconds East leaving the East line of said Lot 8 and along the Southeasterly line of Lots 18 & 19 in said Block 5 a distance of 121.79 feet to the Southeast Corner of Lot 20 in said Block 5; thence North 04 degrees, 55 minutes and 27 seconds West leaving the Southeasterly line of said Lots 18 & 19 and along the East line of said Lots 20 & 21 a distance of 148.10 feet; thence South 82 degrees, 36 minutes and 24 seconds East leaving the East line of said Lot 21 a distance of 324.33 feet to the Northwest Corner of Lot 16 of Block 6 of said Kaskaskia Hills “Lake Mildred” Subdivision Plat, from which a 5/8” iron pin bears North 74 degrees, 57 minutes and 34 seconds East 22.53 feet; thence North 74 degrees, 57 minutes and 34 seconds East along the North line of said Lot 16 a distance of 116.69 feet to the Point of Beginning, containing 33.8 Acres, more or less, with the above described being subject to easements and rights-of-way of record or not of record, if any. As per survey #2023-007897 of John D. Janes, Illinois Professional Land Surveyor #035-04044 during February of 2023.

February 24, 2023

Prepared by
JANES SURVEYING, Inc.
222 South Main
Palmyra, Missouri 63461



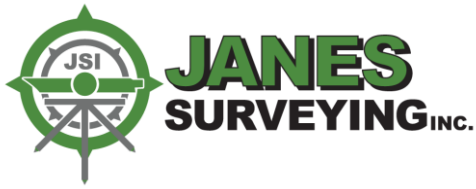

Description – Jeffrey & Marcia Watters and Claud & Ann Watters
4.8 Acre Tract #7A

2023-007897
February 24, 2023

Suggested legal description:

All of Lots 1, 2, 3, 4, 7, 10, 13, 14, 16, 17, 18, 24, 25, 26, 27, 28, 29, 30, 31, 32 & 33 of Block 10 of Kaskaskia Hills “Lake Mildred” Subdivision Plat 2, a subdivision lying in the Southwest Quarter of Section 5 and in Survey #743, Claim #93, Township 5 South, Range 9 West of the 3rd Principal Meridian, Monroe County, Illinois. As per survey #2023-007897 of John D. Janes, Illinois Professional Land Surveyor #035-04044 during February of 2023.

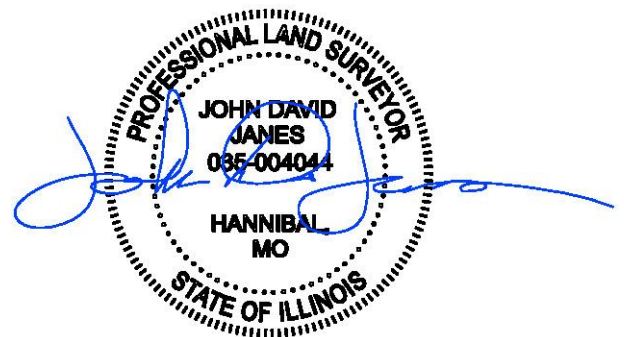

February 24, 2023

Prepared by
JANES SURVEYING, Inc.
222 South Main
Palmyra, Missouri 63461



Description – Jeffrey & Marcia Watters and Claud & Ann Watters
6,919 Square Feet Tract #7B

2023-007897
February 24, 2023

Suggested legal description:

All of Lot 1 of Block 12 of Kaskaskia Hills “Lake Mildred” Subdivision Plat 2, a subdivision lying in the Southwest Quarter of Section 5 and in Survey #743, Claim #93, Township 5 South, Range 9 West of the 3rd Principal Meridian, Monroe County, Illinois. As per survey #2023-007897 of John D. Janes, Illinois Professional Land Surveyor #035-04044 during February of 2023.

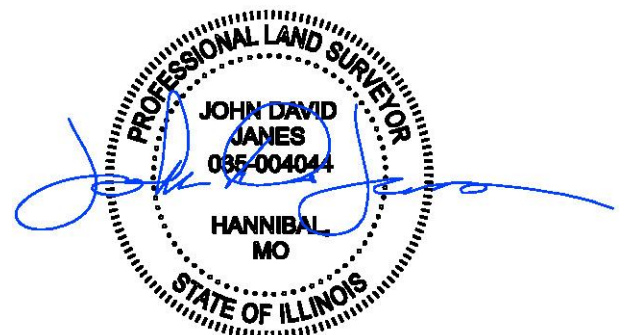

February 24, 2023

Prepared by
JANES SURVEYING, Inc.
222 South Main
Palmyra, Missouri 63461



Description – Jeffrey & Marcia Watters and Claud & Ann Watters
50.00 Feet Wide Roadway & Utility Easement

2023-007897
February 24, 2023

A 50.00 Feet Wide Roadway & Utility Easement lying in the Southwest Quarter of Section 5, Township 5 South, Range 9 West of the 3rd Principal Meridian and lying 25.00 feet each side of the following described line to-wit:

Commencing at the Easternmost Corner of Lot 21 of Block 6 of Kaskaskia Hills “Lake Mildred” Subdivision Plat 2, a subdivision lying in the Southwest Quarter of Section 5 and in Survey #743, Claim #93; thence South 78 degrees, 44 minutes and 22 seconds East 119.30 feet; thence North 11 degrees, 15 minutes and 38 seconds East 25.00 feet to the **True Point of Beginning** of said line; thence South 57 degrees, 25 minutes and 37 seconds East 86.71 feet; thence South 03 degrees, 14 minutes and 29 seconds East 113.73 feet; thence South 57 degrees, 19 minutes and 28 seconds West 311.34 feet; thence South 49 degrees, 01 minute and 40 seconds West 190.80 feet; thence South 38 degrees, 31 minutes and 35 seconds West 114.12 feet; thence South 19 degrees, 29 minutes and 49 seconds West 75.82 feet; thence South 61 degrees, 29 minutes and 11 seconds West 61.21 feet; thence North 47 degrees, 27 minutes and 35 seconds West 149.50 feet; thence North 62 degrees, 51 minutes and 06 seconds West 26.26 feet; thence North 79 degrees, 10 minutes and 10 seconds West 59.25 feet; thence South 82 degrees, 43 minutes and 54 seconds West 73.31 feet; thence South 69 degrees, 21 minutes and 17 seconds West 63.45 feet; thence South 48 degrees, 52 minutes and 12 seconds West 321.97 feet; thence North 72 degrees, 20 minutes and 03 seconds West 58.77 feet; thence North 55 degrees, 55 minutes and 19 seconds West 492.78 feet to the South line of Black Oak Drive and the Point of Termination of said line. As per survey #2023-007897 of John D. Janes, Illinois Professional Land Surveyor #035-04044 during February of 2023.

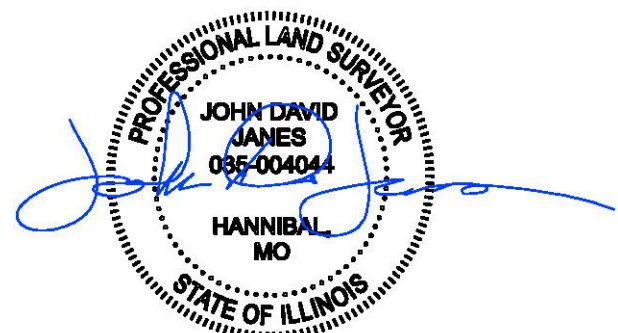

Prepared by
JANES SURVEYING, Inc.
222 South Main
Palmyra, Missouri 63461

February 24, 2023