

Soils Map

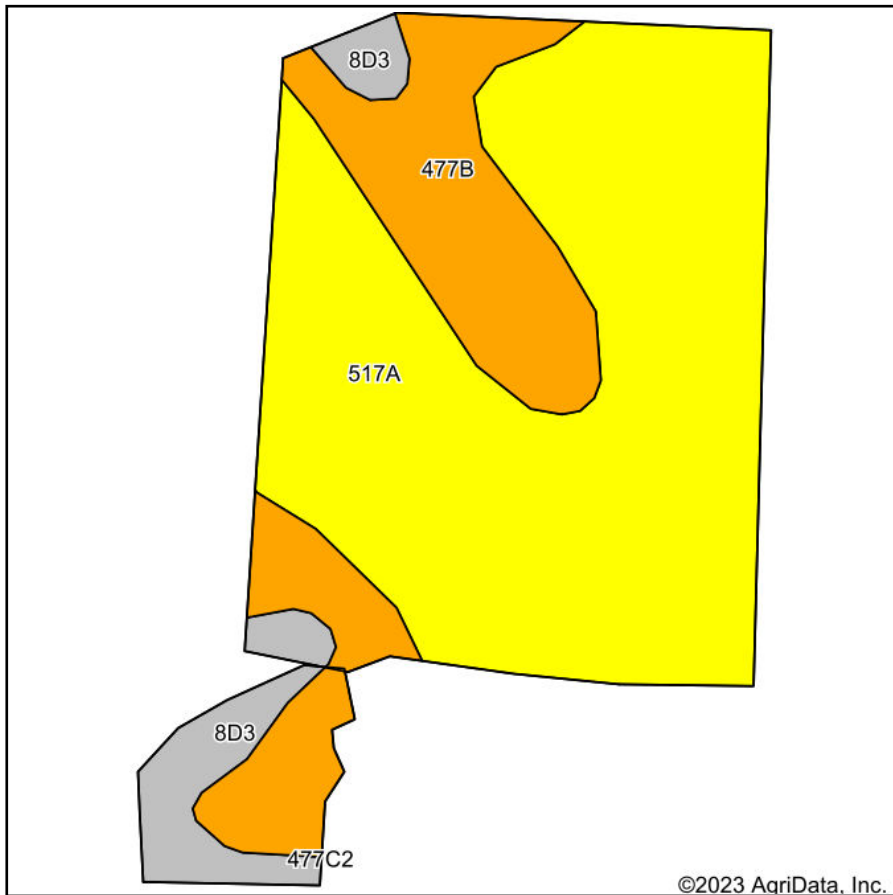

Soils data provided by USDA and NRCS.

©2023 AgriData, Inc.

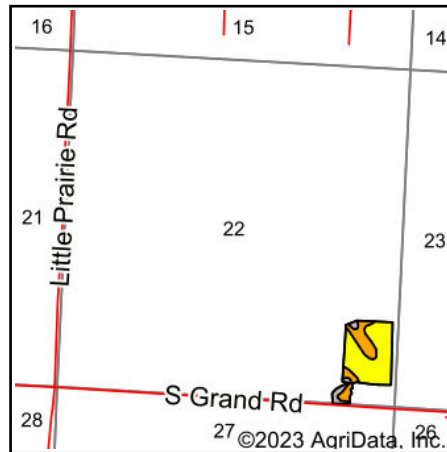

State: **Illinois**
 County: **Washington**
 Location: **22-2S-4W**
 Township: **Plum Hill**
 Acres: **18.5**
 Date: **3/24/2023**



Maps Provided By:



© AgriData, Inc. 2023

www.AgriDataInc.com



Area Symbol: IL189, Soil Area Version: 17

Code	Soil Description	Acres	Percent of field	Il. State Productivity Index Legend	Corn Bu/A	Soybeans Bu/A	Wheat Bu/A	Alfalfa ^d hay, T/A	Crop productivity index for optimum management
517A	Marine silt loam, 0 to 2 percent slopes	12.49	67.5%		144	45	56	3.39	104
**477B	Winfield silt loam, 2 to 5 percent slopes	4.57	24.7%		**160	**50	**62	**4.97	**118
**8D3	Hickory clay loam, 10 to 18 percent slopes, severely eroded	1.44	7.8%		**98	**33	**40	**3.26	**75
Weighted Average					144.4	45.3	56.2	3.77	105.2

Table: Optimum Crop Productivity Ratings for Illinois Soil by K.R. Olson and J.M. Lang, Office of Research, ACES, University of Illinois at Champaign-Urbana. Version: 1/2/2012 Amended Table S2 B811

Crop yields and productivity indices for optimum management (B811) are maintained at the following NRES web site: <http://soilproductivity.nres.illinois.edu/>

** Indexes adjusted for slope and erosion according to Bulletin 811 Table S3

^d Soils in the poorly drained group were not rated for alfalfa and are shown with a zero "0".

Soils data provided by USDA and NRCS. Soils data provided by University of Illinois at Champaign-Urbana.