

Soils Map

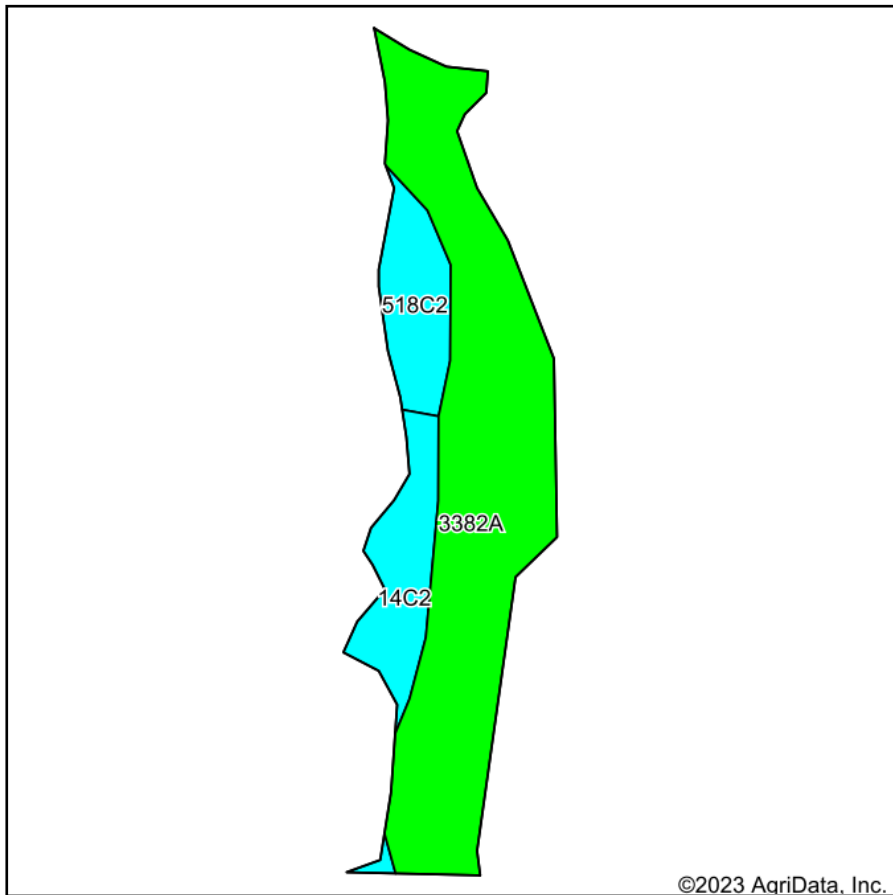

Soils data provided by USDA and NRCS.

©2023 AgriData, Inc.

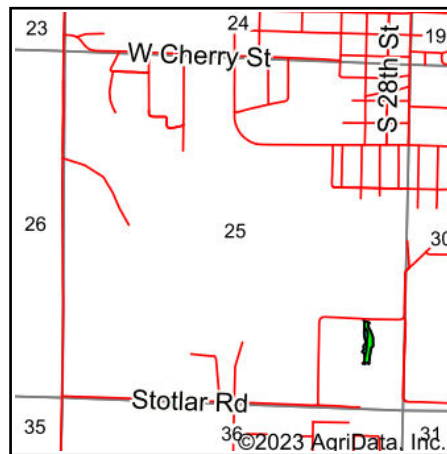

State: **Illinois**
 County: **Williamson**
 Location: **25-8S-1E**
 Township: **Blairsville**
 Acres: **1.53**
 Date: **6/14/2023**



Maps Provided By:



© AgriData, Inc. 2023

www.AgriDataInc.com



Area Symbol: IL199, Soil Area Version: 17

Code	Soil Description	Acres	Percent of field	II. State Productivity Index Legend	Corn Bu/A	Soybeans Bu/A	Wheat Bu/A	Alfalfa <i>d</i> hay, T/A	Crop productivity index for optimum management
3382A	Belknap silt loam, 0 to 2 percent slopes, frequently flooded	1.12	73.2%		156	52	63	0.00	117
**14C2	Ava silt loam, 5 to 10 percent slopes, eroded	0.22	14.4%		**122	**40	**50	**2.93	**90
**518C2	Rend silt loam, 5 to 10 percent slopes, eroded	0.19	12.4%		**128	**40	**50	**3.39	**95
Weighted Average					147.6	48.8	59.5	0.84	110.4

Table: Optimum Crop Productivity Ratings for Illinois Soil by K.R. Olson and J.M. Lang, Office of Research, ACES, University of Illinois at Champaign-Urbana. Version: 1/2/2012 Amended Table S2 B811

Crop yields and productivity indices for optimum management (B811) are maintained at the following NRES web site: <http://soilproductivity.nres.illinois.edu/>

** Indexes adjusted for slope and erosion according to Bulletin 811 Table S3

d Soils in the poorly drained group were not rated for alfalfa and are shown with a zero "0".

Soils data provided by USDA and NRCS. Soils data provided by University of Illinois at Champaign-Urbana.