

Soils Map

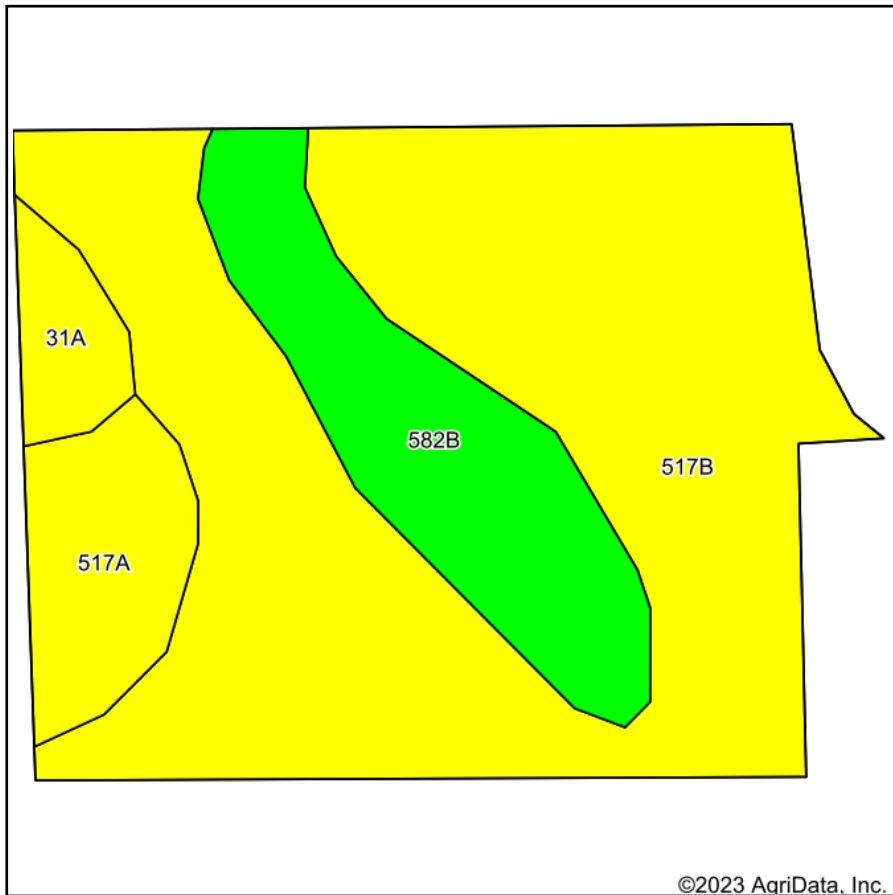

Soils data provided by USDA and NRCS.

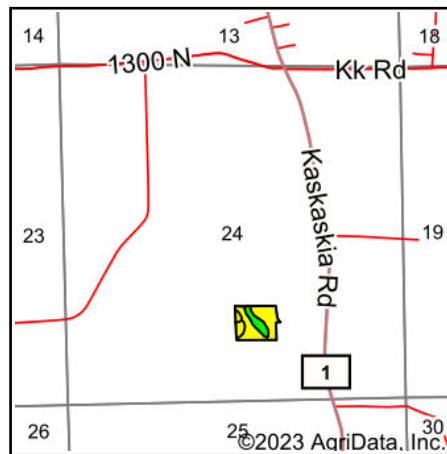

State: **Illinois**
 County: **Monroe**
 Location: **24-3S-10W**
 Township: **Precinct 23**
 Acres: **7.9**
 Date: **6/14/2023**



Maps Provided By:



Area Symbol: IL133, Soil Area Version: 15

Code	Soil Description	Acres	Percent of field	Il. State Productivity Index Legend	Corn Bu/A	Soybeans Bu/A	Wheat Bu/A	Alfalfa <i>d</i> hay, T/A	Crop productivity index for optimum management
**517B	Marine silt loam, 2 to 5 percent slopes	5.50	69.6%		**143	**45	**55	**3.36	**103
**582B	Homen silt loam, 2 to 5 percent slopes	1.43	18.1%		**149	**47	**55	**3.72	**108
517A	Marine silt loam, 0 to 2 percent slopes	0.67	8.5%		144	45	56	3.39	104
31A	Pierron silt loam, 0 to 2 percent slopes	0.30	3.8%		136	43	55	0.00	102
Weighted Average					143.9	45.3	55.1	3.30	104

Table: Optimum Crop Productivity Ratings for Illinois Soil by K.R. Olson and J.M. Lang, Office of Research, ACES, University of Illinois at Champaign-Urbana. Version: 1/2/2012 Amended Table S2 B811

Crop yields and productivity indices for optimum management (B811) are maintained at the following NRES web site: <http://soilproductivity.nres.illinois.edu/>

** Indexes adjusted for slope and erosion according to Bulletin 811 Table S3

d Soils in the poorly drained group were not rated for alfalfa and are shown with a zero "0".

Soils data provided by USDA and NRCS. Soils data provided by University of Illinois at Champaign-Urbana.