

PLAT OF SURVEY

PART OF SOUTHEAST QUARTER OF THE SOUTHWEST QUARTER OF SECTION 19,
TOWNSHIP 2 SOUTH, RANGE 1 WEST OF THE THIRD PRINCIPAL MERIDIAN,
WASHINGTON COUNTY, ILLINOIS.

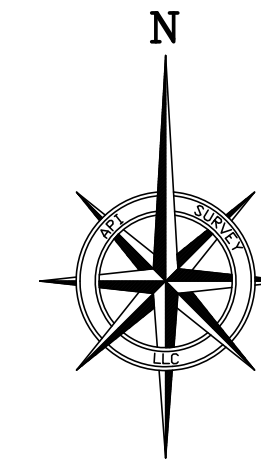

SCALE 1" = 100'
BASIS OF BEARING
ILLINOIS STATE PLANE WEST
ZONE GRID BEARINGS
NAD 83

LEGEND

- ▲ STONE FOUND
- IRON PIN FOUND
- FENCE POST FOUND
- IRON PIN SET
- IRON PIN SET PREVIOUSLY
- 50.00'(R) RECORD DISTANCE
- 50.00' MEASURED DISTANCE

DEED DESCRIPTION – (BK 441 PG 791)

TWENTY-FIVE (25) ACRES OFF OF THE WEST SIDE OF THE SOUTHEAST QUARTER OF THE SOUTHWEST QUARTER OF SECTION 19, TOWNSHIP 2 SOUTH, RANGE 1 WEST OF THE THIRD PRINCIPAL MERIDIAN, SITUATED IN WASHINGTON COUNTY, ILLINOIS.

SURVEYOR'S NOTE:

- 1.) THE SE 1/4 – SW 1/4 OF SECTION 19 WAS CONVEYED TO MARTHA SMITH BY DEED BK 94 PG 311 RECORDED ON 4/6/1898.
- 2.) MARTHA SMITH THEN CONVEYED 25 ACRES OFF OF THE WEST PART OF THE SE 1/4 – SW 1/4 TO CHRIS SCHUBACH BY DEED BK 114 PG 450 RECORDED ON 6/12/1909.
- 3.) ON 2/14/1910 COUNTY SURVEYOR W.B. ANDERSON SURVEYED 25 ACRES OFF OF THE WEST SIDE OF THE SE 1/4 – SW 1/4 FOR C. SCHUBACH & SMITH (SEE SURVEY BK 1 PG 112).
- 4.) MARTHA SMITH CONVEYED THE REMAINDER OF THE SE 1/4 – SW 1/4 AS THE E 1/2 – SE 1/4 – SW 1/4 CONTAINING 21 ACRES, MORE OR LESS, TO THOMAS PAYTON SMITH BY DEED BK 132 PG 281 RECORDED ON 12/3/1919.

CERTIFICATION

THIS IS TO CERTIFY THAT AT THE REQUEST OF BILL ROSKOWSKI, I HAVE SURVEYED AND PLATTED THE PROPERTY DESCRIBED AND SHOWN HEREON AND DO HEREBY CERTIFY THAT THIS PLAT IS A TRUE REPRESENTATION THEREOF. SURVEY IS SUBJECT TO EASEMENTS AND RIGHTS OF WAY OF RECORD.

Jack A. Gelsso 10/21/2020
DATE
JACK A. GELSO
ILLINOIS PROFESSIONAL LAND SURVEYOR NO. 3786
(LICENSE EXPIRATION/RENEWAL DATE: 11-30-20)

THIS PROFESSIONAL SERVICE CONFORMS TO THE CURRENT ILLINOIS MINIMUM STANDARDS FOR A BOUNDARY SURVEY.

FIELD WORK COMPLETED OCTOBER 20, 2020.

RECORDS REFERENCED:

DEEDS AS LISTED HEREON
MONUMENT RECORD LISTED HEREON
SURVEY BOOK 1 PG 112
PLAT OF SURVEY BY PLS #3786
DATED 5/16/2017, FOR NATHAN GUINZY

API Survey LLC
17825 Mockingbird Road
P.O. Box 333
Nashville, Illinois 62263
Ph. 618-478-9001
Ph. 618-478-9000
Email: gary@apisurvey.com
IDPR Design Firm License No. 184-006526

DRAWN: JAG SURVEY: MC, JS
DWG NAME: 20-142 Plat JOB NO.: 20-142

