

# Soils Map

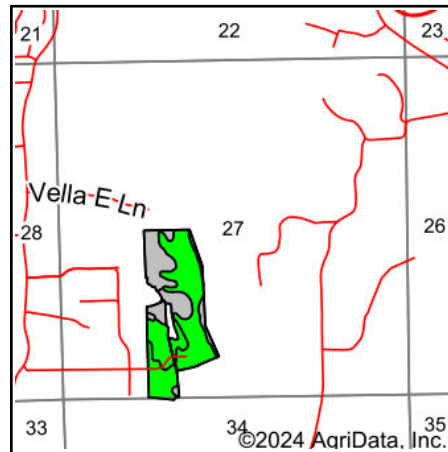

State: **Illinois**  
 County: **Monroe**  
 Location: **27-1S-10W**  
 Township: **Precinct 21**  
 Acres: **45.21**  
 Date: **11/14/2024**

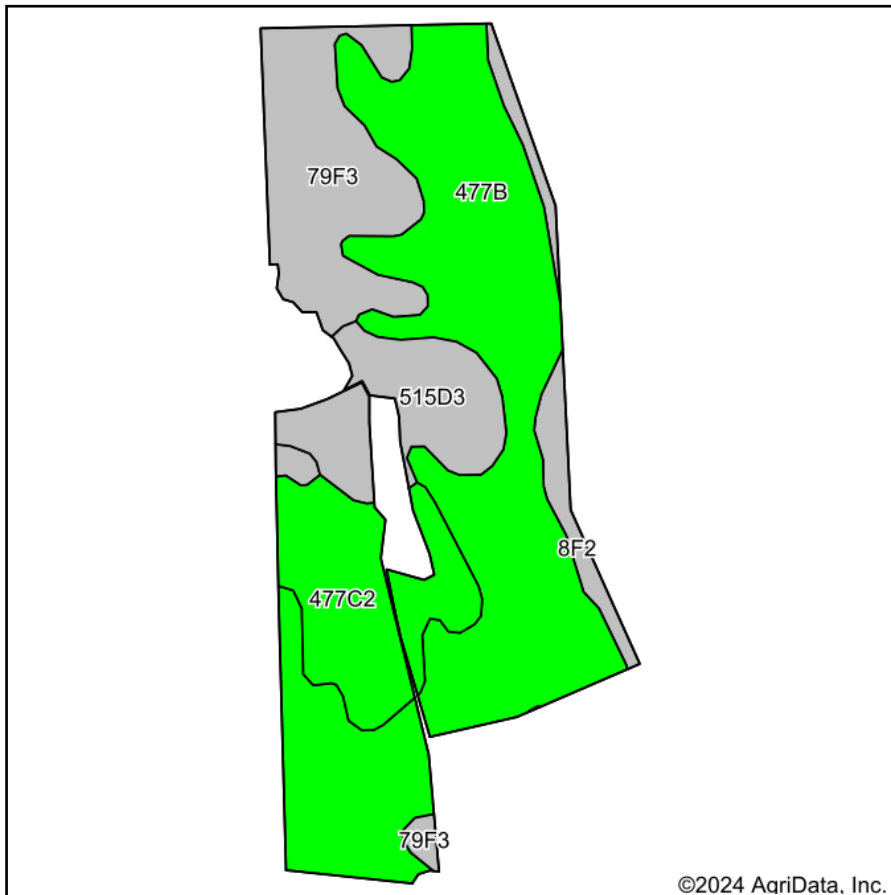

Area Symbol: IL133, Soil Area Version: 17

Code	Soil Description	Acres	Percent of field	Il. State Productivity Index Legend	Subsoil rooting <sup>a</sup>	Corn Bu/A	Soybeans Bu/A	Wheat Bu/A	Oats Bu/A <sup>b</sup>	Sorghum <sup>c</sup> Bu/A	Grass-legume <sup>e</sup> hay, T/A	Crop productivity index for optimum management
**477B	Winfield silt loam, 2 to 5 percent slopes	24.07	53.2%		FAV	**159	**49	**62	0	**121	**4.90	**117
**79F3	Menfro silty clay loam, 18 to 35 percent slopes, severely eroded	7.87	17.4%		FAV	**99	**31	**38	0	**73	**2.90	**72
**477C2	Winfield silt loam, 5 to 10 percent slopes, eroded	6.49	14.4%		FAV	**151	**47	**59	0	**114	**4.70	**111
**515D3	Bunkum silty clay loam, 10 to 18 percent slopes, severely eroded	4.78	10.6%		FAV	**115	**40	**44	0	**89	**3.10	**87
**8F2	Hickory silt loam, 18 to 35 percent slopes, eroded	2.00	4.4%		FAV	**82	**28	**34	**38	0	**2.70	**63
<b>Weighted Average</b>						<b>139.3</b>	<b>43.7</b>	<b>54.2</b>	<b>1.7</b>	<b>102.9</b>	<b>4.2</b>	<b>102.7</b>

**Table: Optimum Crop Productivity Ratings for Illinois Soil EFOTG are sourced from Bulletin 811 calculated Map Unit Base Yield Indices, and adjusted (Adj) for slope, erosion, flooding, and surface texture.** Publication Date: 02-08-2023

Crop yields and productivity (B811 EFOTG) are maintained at the following USDA web site: 2023 Illinois Soil Productivity and Yield Indices: <https://efotg.sc.egov.usda.gov/#/state/IL/documents/section=2&folder=52809>

\*\* Base indexes from Bulletin 811 adjusted for slope, erosion, flooding, and surface texture according to the Il. Soils EFOTG

<sup>b</sup> Soils in the southern region were not rated for oats and are shown with a zero "0".

<sup>c</sup> Soils in the northern region or in both regions were not rated for grain sorghum and are shown with a zero "0".

<sup>e</sup> Soils in the well drained group were not rated for grass-legume and are shown with a zero "0".

Soils data provided by USDA and NRCS. Soils data provided by University of Illinois at Champaign-Urbana.