

PLAT OF SURVEY

PART OF THE EAST HALF OF SECTION 7 AND PART OF THE WEST HALF OF SECTION 8,
ALL IN TOWNSHIP 4 SOUTH, RANGE 9 WEST OF THE THIRD PRINCIPAL MERIDIAN,
MONROE COUNTY, ILLINOIS.

MM ROAD LINE TABLE			RECORD
LINE NO.	BEARING	DISTANCE	DISTANCE (R)
L1	S72°59'50"E	21.34'	21.34'(R)
L2	N56°31'02"E	175.04'	175.04'(R)
L3	N52°15'56"E	46.27'	46.27'(R)
L4	N52°00'54"E	43.84'	43.85'(R)
L5	N51°25'50"E	235.55'	235.55'(R)

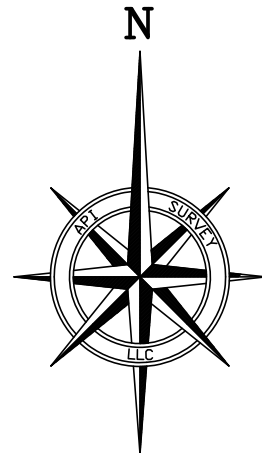

SCALE: 1" = 200'

BASIS OF BEARINGS
BEARINGS ARE REFERENCED TO THE WEST
LINE NE 1/4 - SE 1/4 &
SE 1/4 - NE 1/4 OF SECTION 7
PER DOC. 300140

LEGEND

- STONE FOUND
- IRON PIN FOUND
- RAILROAD SPIKE FOUND
- IRON PIN SET
- MAG SPIKE SET
- 50.00'(R) RECORD DISTANCE
- 50.00' MEASURED DISTANCE
- SAME OWNERSHIP

RECORDS REFERENCED:
DEEDS AS LISTED HEREON

PLAT OF SURVEY BY PLS #2973
FOR MIKE HENRY, DATED 12/30/2003

PLAT OF SURVEY BY PLS #2973
FOR SCOTT VOGT, DATED 3/9/2006

LEGAL DESCRIPTION - TRACT "A"

THAT PART OF THE NORTHEAST QUARTER OF THE SOUTHEAST QUARTER AND THAT PART OF THE SOUTHEAST QUARTER OF THE NORTHEAST QUARTER OF SECTION 7, AND THAT PART OF THE WEST HALF SOUTHWEST QUARTER OF THE NORTHWEST QUARTER AND THAT PART OF THE WEST HALF OF THE NORTHWEST QUARTER OF THE SOUTHWEST QUARTER OF SECTION 8, ALL IN TOWNSHIP 4 SOUTH, RANGE 9 WEST OF THE THIRD PRINCIPAL MERIDIAN, MONROE COUNTY, ILLINOIS, DESCRIBED AS FOLLOWS:

COMMENCING AT A STONE AT THE SOUTHWEST CORNER OF THE NORTHEAST QUARTER OF THE SOUTHEAST QUARTER OF SAID SECTION 7; THENCE NORTH 00°14'23" EAST ON THE WESTERLY LINE OF SAID NORTHEAST QUARTER OF THE SOUTHEAST QUARTER, 990.00 FEET TO AN IRON PIN FOUND AT THE SOUTHWEST CORNER OF A TRACT OF LAND DESCRIBED IN QUIT CLAIM DEED TO TINA M. HENRY AND MICHAEL E. HENRY RECORDED AUGUST 29, 2005 IN DOCUMENT NUMBER 300139 IN THE RECORDER'S OFFICE OF MONROE COUNTY, ILLINOIS, SAID POINT BEING THE POINT OF BEGINNING; THENCE CONTINUING NORTH 00°14'23" EAST ON SAID WESTERLY LINE AND THE WESTERLY LINE OF THE OF SOUTHEAST QUARTER OF THE NORTHEAST QUARTER, 807.21 FEET TO AN IRON PIN SET; THENCE SOUTH 76°15'59" EAST, 350.00 FEET TO AN IRON PIN SET; THENCE SOUTH 67°22'38" EAST, 493.50 FEET TO AN IRON PIN SET; THENCE SOUTH 01°20'33" WEST, 218.50 FEET TO AN IRON PIN SET; THENCE NORTH 88°34'22" EAST, 1045.00 FEET TO AN IRON PIN SET; THENCE NORTH 00°08'31" EAST, 506.82 FEET TO AN IRON PIN SET; THENCE NORTH 89°21'47" WEST, 1392.37 FEET TO AN IRON PIN SET; THENCE NORTH 57°07'42" WEST, 527.00 FEET TO A MAG SPIKE SET ON SAID WESTERLY LINE OF THE SOUTHEAST QUARTER OF THE NORTHEAST QUARTER, SAID LINE ALSO BEING THE WESTERLY LINE OF A TRACT OF LAND DESCRIBED IN QUIT CLAIM DEED TO TINA M. HENRY AND MICHAEL E. HENRY RECORDED AUGUST 29, 2005 IN DOCUMENT NUMBER 300140 IN SAID RECORDER'S OFFICE; THENCE NORTH 00°14'23" EAST ON SAID WESTERLY LINE, 214.65 FEET TO AN IRON PIN FOUND ON THE CENTERLINE OF MM ROAD; THENCE ON SAID CENTERLINE THE FOLLOWING FIVE (5) COURSES AND DISTANCES: 1) THENCE SOUTH 72°59'50" EAST, 21.34 FEET TO AN IRON PIN FOUND; 2) THENCE NORTH 56°31'02" EAST, 175.04 FEET TO AN IRON PIN FOUND; 3) THENCE NORTH 52°15'56" EAST, 46.27 FEET TO A RAILROAD SPIKE FOUND; 4) THENCE NORTH 52°00'54" EAST, 43.84 FEET TO AN IRON PIN FOUND; 5) THENCE NORTH 51°25'50" EAST, 235.55 FEET TO AN IRON PIN FOUND AT THE MOST NORTHERLY CORNER OF SAID HENRY TRACT (DOC. 300140); THENCE ON THE NORTHERLY LINE OF SAID HENRY TRACT THE FOLLOWING TWO (2) COURSES AND DISTANCES: 1) THENCE SOUTH 38°00'00" EAST, 581.02 FEET TO AN IRON PIN FOUND; 2) THENCE NORTH 81°15'00" EAST, 1003.00 FEET TO AN IRON PIN FOUND AT THE SOUTHWEST CORNER OF A TRACT OF LAND DESCRIBED IN WARRANTY DEED TO SCOTT D. VOGT RECORDED APRIL 26, 2006 IN DOCUMENT NUMBER 306001 IN SAID RECORDER'S OFFICE; THENCE CONTINUING NORTH 81°15'00" EAST ON THE SOUTH LINE OF SAID VOGT TRACT, 212.04 FEET TO AN IRON PIN FOUND ON THE EASTERLY LINE OF SAID HENRY TRACT (DOC. 300140), SAID LINE ALSO BEING THE EASTERLY LINE OF THE WEST HALF OF THE SOUTHWEST QUARTER OF THE NORTHWEST QUARTER OF SAID SECTION 8; THENCE SOUTH 00°08'31" WEST ON SAID EASTERLY LINE, 1388.11 FEET TO AN IRON PIN FOUND AT THE SOUTHEAST CORNER OF SAID HENRY TRACT; THENCE ON THE SOUTHERLY LINE OF SAID HENRY TRACT THE FOLLOWING TWO (2) COURSES AND DISTANCES: 1) THENCE NORTH 89°05'29" WEST, 666.78 FEET TO AN IRON PIN FOUND; 2) THENCE SOUTH 89°42'16" WEST, 1315.92 FEET TO THE POINT OF BEGINNING.

CONTAINING 44.50 ACRES, MORE OR LESS, AND IS SUBJECT TO THE RIGHT OF WAY OF MM ROAD AND G ROAD AND IS SUBJECT TO ALL OTHER EASEMENTS AND RIGHTS OF WAY OF RECORD.

LEGAL DESCRIPTION - TRACT "B" (REMAINDER)

THAT PART OF THE NORTHEAST QUARTER OF THE SOUTHEAST QUARTER AND THAT PART OF THE SOUTHEAST QUARTER OF THE NORTHEAST QUARTER OF SECTION 7, AND THAT PART OF THE WEST HALF SOUTHWEST QUARTER OF THE NORTHWEST QUARTER AND THAT PART OF THE WEST HALF OF THE NORTHWEST QUARTER OF THE SOUTHWEST QUARTER OF SECTION 8, ALL IN TOWNSHIP 4 SOUTH, RANGE 9 WEST OF THE THIRD PRINCIPAL MERIDIAN, MONROE COUNTY, ILLINOIS, DESCRIBED AS FOLLOWS:

COMMENCING AT A STONE AT THE SOUTHWEST CORNER OF THE NORTHEAST QUARTER OF THE SOUTHEAST QUARTER OF SAID SECTION 7; THENCE NORTH 00°14'23" EAST ON THE WESTERLY LINE OF SAID NORTHEAST QUARTER OF THE SOUTHEAST QUARTER AND THE WESTERLY LINE OF THE SOUTHEAST QUARTER OF THE NORTHEAST QUARTER OF SAID SECTION 7, A DISTANCE OF 1797.21 FEET TO AN IRON PIN SET AND THE POINT OF BEGINNING; THENCE CONTINUING NORTH 00°14'23" EAST ON SAID WESTERLY LINE, 343.00 FEET TO MAG SPIKE SET; THENCE SOUTH 57°07'42" EAST, 527.00 FEET TO AN IRON PIN SET; THENCE SOUTH 89°21'47" EAST, 1392.37 FEET TO AN IRON PIN SET; THENCE SOUTH 00°08'31" WEST, 506.82 FEET TO AN IRON PIN SET; THENCE SOUTH 88°34'22" WEST, 1045.00 FEET TO AN IRON PIN SET; THENCE NORTH 01°20'33" EAST, 218.50 FEET TO AN IRON PIN SET; THENCE NORTH 67°22'38" WEST, 493.50 FEET TO AN IRON PIN SET; THENCE NORTH 76°15'59" WEST, 350.00 FEET TO THE POINT OF BEGINNING.

CONTAINING 17.23 ACRES, MORE OR LESS, AND IS SUBJECT TO THE RIGHT OF WAY OF G ROAD AND IS SUBJECT TO ALL OTHER EASEMENTS AND RIGHTS OF WAY OF RECORD.

CERTIFICATION

THIS IS TO CERTIFY THAT AT THE REQUEST OF MIKE HENRY, I HAVE SURVEYED, DIVIDED AND PLATTED THE PROPERTY DESCRIBED AND SHOWN HEREON AND DO HEREBY CERTIFY THAT THIS PLAT IS A TRUE REPRESENTATION THEREOF. SURVEY IS SUBJECT TO EASEMENTS AND RIGHTS OF WAY OF RECORD.

Jack A. Gels 8/18/2023
JACK A. GELSO DATE
ILLINOIS PROFESSIONAL LAND SURVEYOR NO. 3786
(LICENSE EXPIRATION/RENEWAL DATE: 11-30-24)

THIS PROFESSIONAL SERVICE CONFORMS TO THE CURRENT ILLINOIS MINIMUM STANDARDS FOR A BOUNDARY SURVEY.

FIELD WORK COMPLETED AUGUST 17, 2023.



API Survey LLC
11145 N. Mockingbird Road
Suite A
P.O. Box 333
Nashville, Illinois 62263
Ph. 618-476-9000
Email: gary@apisurvey.com
IDPR Design Firm License No. 184-006526

DRAWN: JAG	SURVEY: DP, DM, KD
DWG NAME: 23-132 Plat	JOB NO.: 23-132